

SPECIFICATION

• NOMINAL VOLTAGE	: 12 V
• NOMINAL CAPACITY(20 hr)	: 35.0 Ah
• DIMENSIONS	
TOTAL HEIGHT	: 170 mm (6.69 inches)
CONTAINER HEIGHT	: 170 mm (6.69 inches)
LENGTH	: 198 mm (7.80 inches)
WIDTH	: 132 mm (5.20 inches)
• WEIGHT	: APPROX 13.23 Kg (29.17lbs)
• CONTAINER MATERIAL	: UL94HB ABS
	: UL94V-0 ABS
• INTERNAL RESISTANCE(25°C , 77 °F)	: ~8mΩ
• DISCHARGE CAPACITY UNDER DIFFERENT TEMPERATURES	
40°C	: ~102%
25°C	: ~100%
0 °C	: ~85%



General Application

SA12350 is a general purpose battery with 3~5 years in standby service or more than 400 cycles at 50% depth of discharge in cycle service.

CHARACTERISTICS

• CAPACITY 25°C / 77 °F	
20 hr @ 1.75 A	: 35 Ah
5 hr @ 5.6 A	: 28Ah
1 hr @ 21 A	: 21 Ah
1 C @ 35A	: 17.5 Ah
• CHARGING VOLTAGE (25°C , 77 °F)	
STANDBY USE	: 13.65V±0.15 V
CYCLE USE	: 14.7V ± 0.3V
• MAX DISCHARGE CURRENT	: 300A (5 sec)
• MAX CHARGING CURRENT	: 10.5 A
• SELF-DISCHARGE RESIDUAL CAPACITY(25°C , 77 °F)	
AFTER 3 MONTHS	: 90%
AFTER 6 MONTHS	: 82%
AFTER 12 MONTHS	: 70%

Discharge Current vs Time

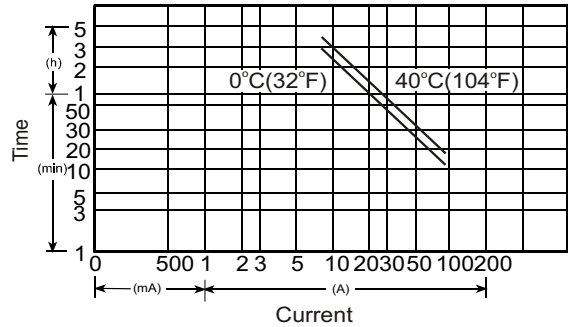

Discharge Characteristics @25 °C (77 °F)

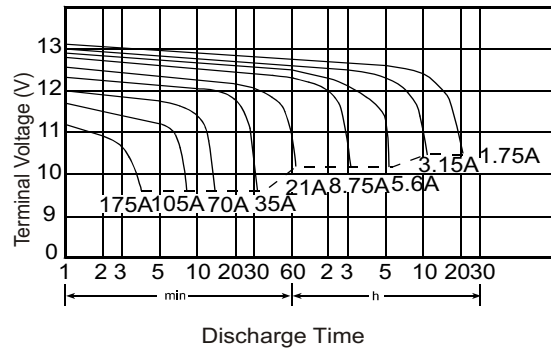

Dimensions

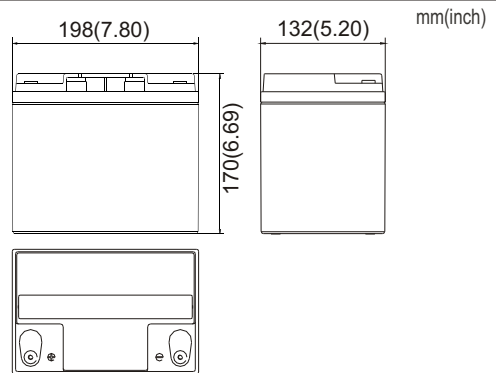

Tolerances are +/-0.04 in. (+/-1mm) and +/-0.08 in. (+/-2mm) for height dimensions.

Terminal

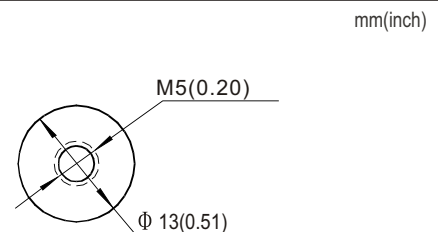

Type:RT-01



Web : www.sota.cc

Note: Specifications are subject to change without further notice.
SOTA ENERTECH INC.